

***South Shore Regional Vocational School District***

**Updates on Admissions  
MSBA Project &  
Regional Agreement**

***Marshfield Select Board***

***May 20, 2024***

# First Year Information: Marshfield Membership & Admissions

***Marshfield's membership begins on July 1, 2024.***

***Marshfield's incoming 9th grade class of 2028:***

- 33 initial seats apportioned based on size of 8th grade class*
- 41 applications; 41 students offered admission*
- 29 students confirmed to attend*

# MSBA Update

For more info: [www.southshoretechproject.com](http://www.southshoretechproject.com)

## Highlights as of May 2024

1. **Project Design**: Narrowed down 30 possible construction and enrollment options.
  - a. Studied a range of enrollments: 645-975 students; Waiting list for 24-25 school year: 120 students district wide
  - b. Addition renovation and new construction considered
  - c. Preferred design for 900 students, new construction
  
1. **Project Timeline**
  - a. Through August 2024: Schematic Design
  - b. October 2024: MSBA Approval
  - c. January 2025: Districtwide ballot question on project
  - d. Cost impact phased in FY26-FY29
  
1. **Regional Agreement**
  - a. Working on an amendment to bring to all town meetings to adjust debt shares to a 4 year rolling average.
  - b. Will provide separate update later in the summer; goal of having Fall 2024 special town meetings act on the amendment.

# MSBA Update: New Design “NC 2.0”

For more info: [www.southshorettechproject.com](http://www.southshorettechproject.com)



Built on existing athletic fields  
Includes new **Plumbing and Veterinary Science** programs.  
Targeted opening **Fall 2028.**



# View of school from street level



OPTION **NC-2.0** 900 Students View from Webster Street

# View of fields in relation to school

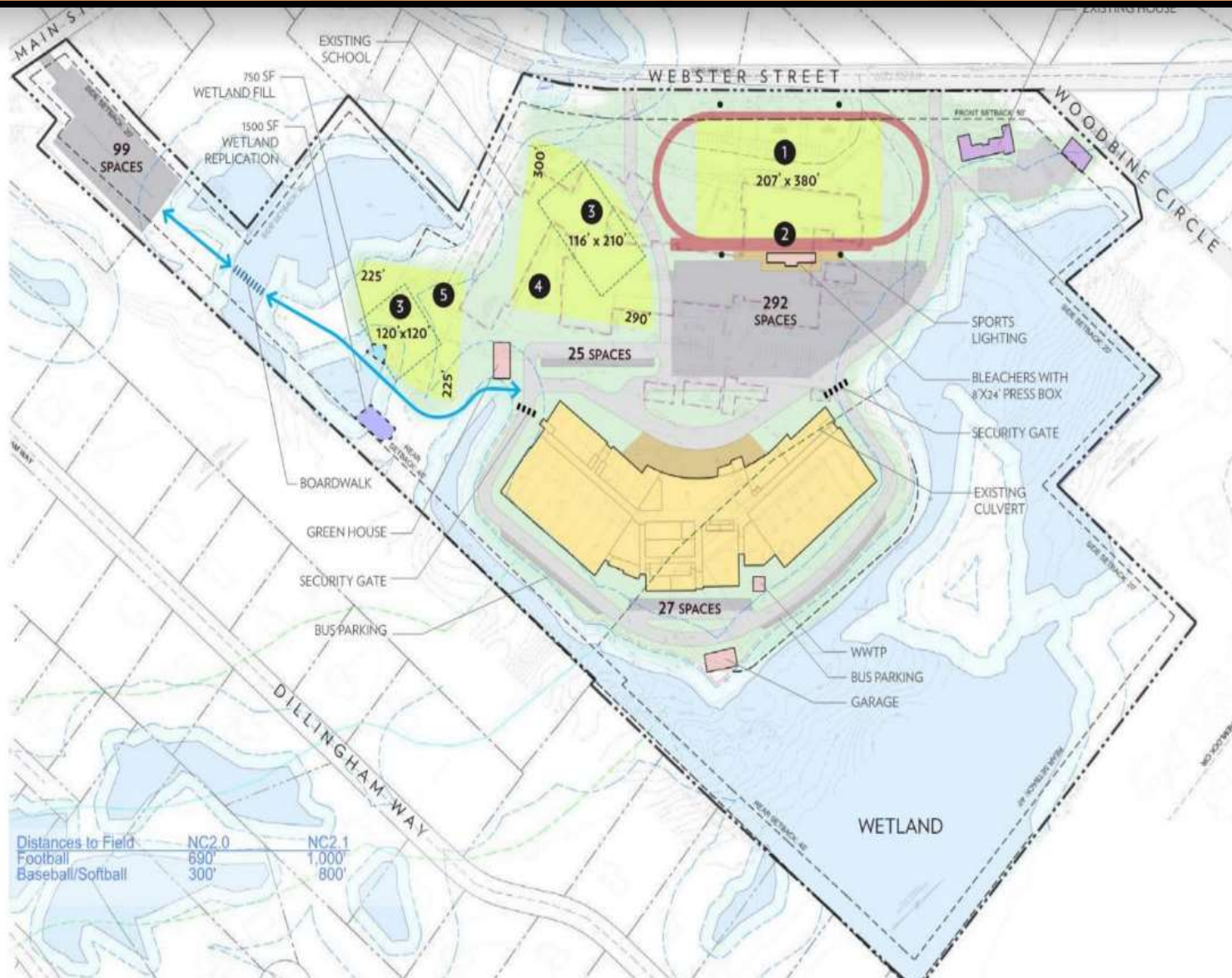

## LEGEND

- EXISTING STRUCTURES
- PROPOSED STRUCTURES
- NEW SCHOOL
- ATHLETICS
- ENTRY PLAZA
- WETLAND
- 35' WETLAND BUFFER
- SECURITY GATE
- 1 SYNTHETIC TURF MULTI-PURPOSE FIELD
- 2 RUNNING TRACK
- 3 PRACTICE FIELD
- 4 BASEBALL
- 5 SOFTBALL

**TOTAL PARKING:**  
 EXISTING: 304 SPACES & 15 BUS SPACES  
 PROPOSED: 344 SPACES (9'x18') & 15 BUS SPACES  
 TARGET: 426 SPACES  
 ADDITIONAL:  
 99 SPACES (MAIN ST.)  
 20 SPACES (EX. HOUSE)

Distances to Field	NC2.0	NC2.1
Football	690'	1,000'
Baseball/Softball	300'	800'

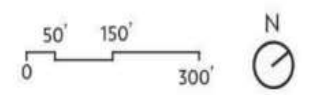



# PREFERRED OPTION

## 1st FLOOR PLANS

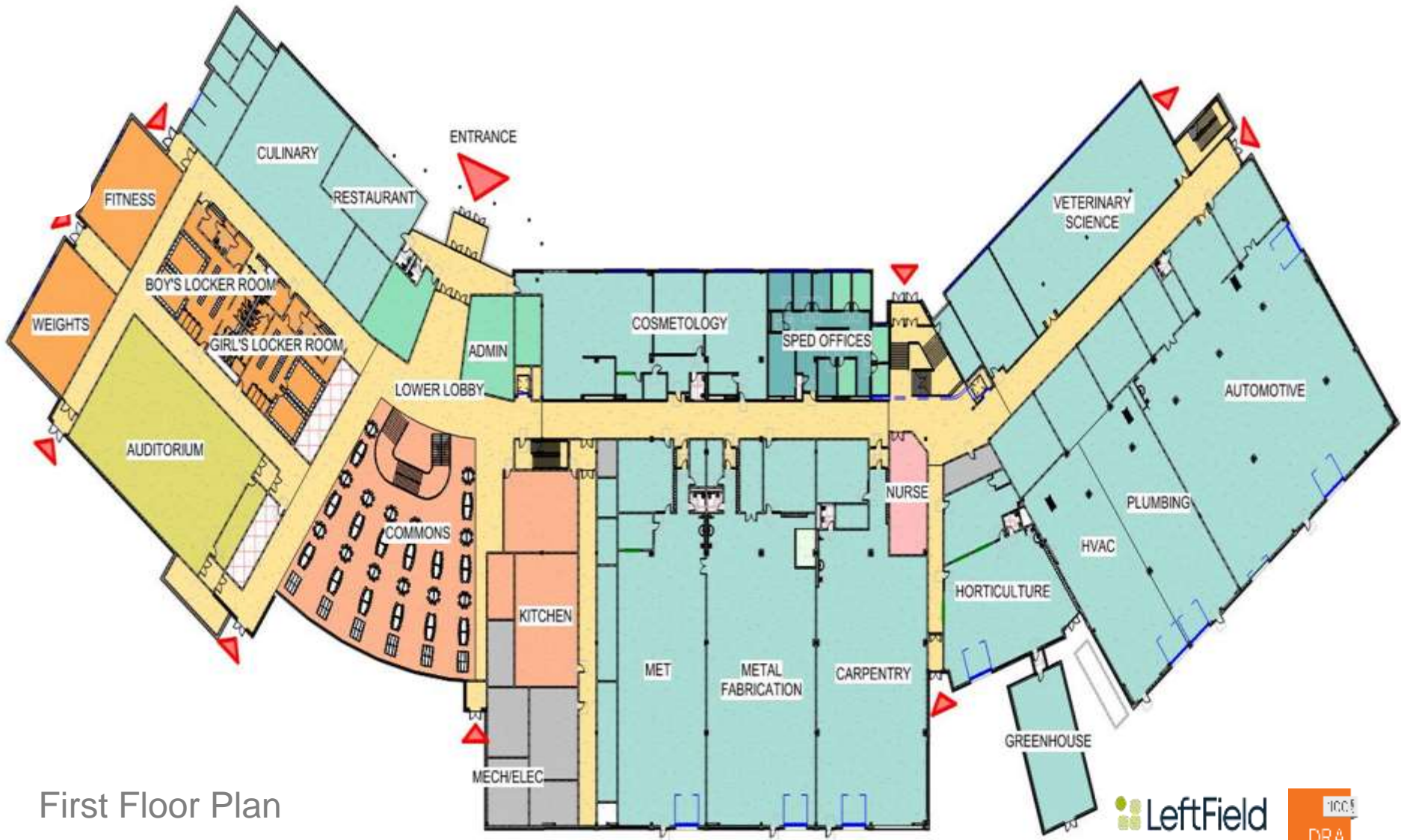

First Floor Plan

# PREFERRED OPTION 2nd FLOOR PLANS

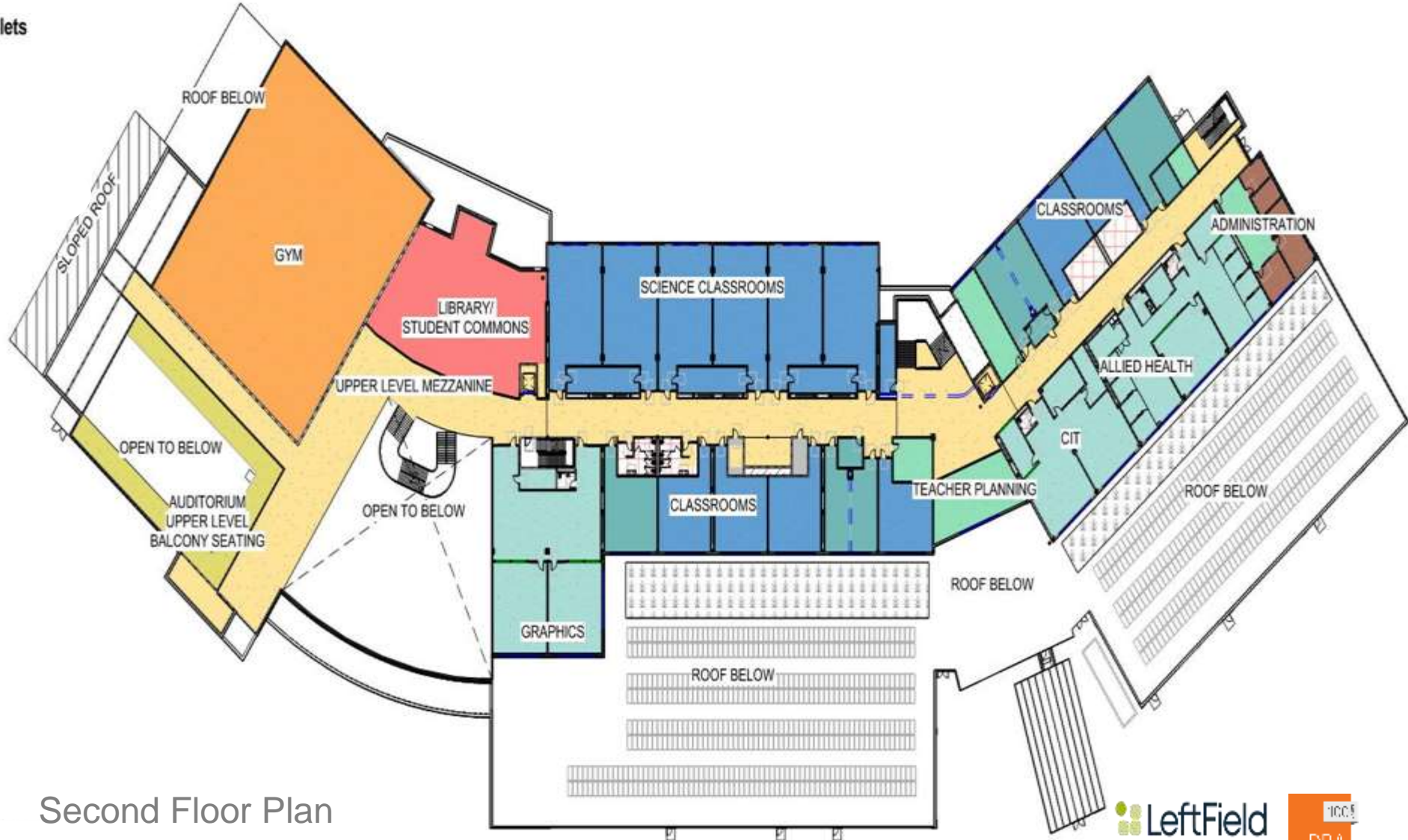

Second Floor Plan



# PREFERRED OPTION 3rd FLOOR PLANS

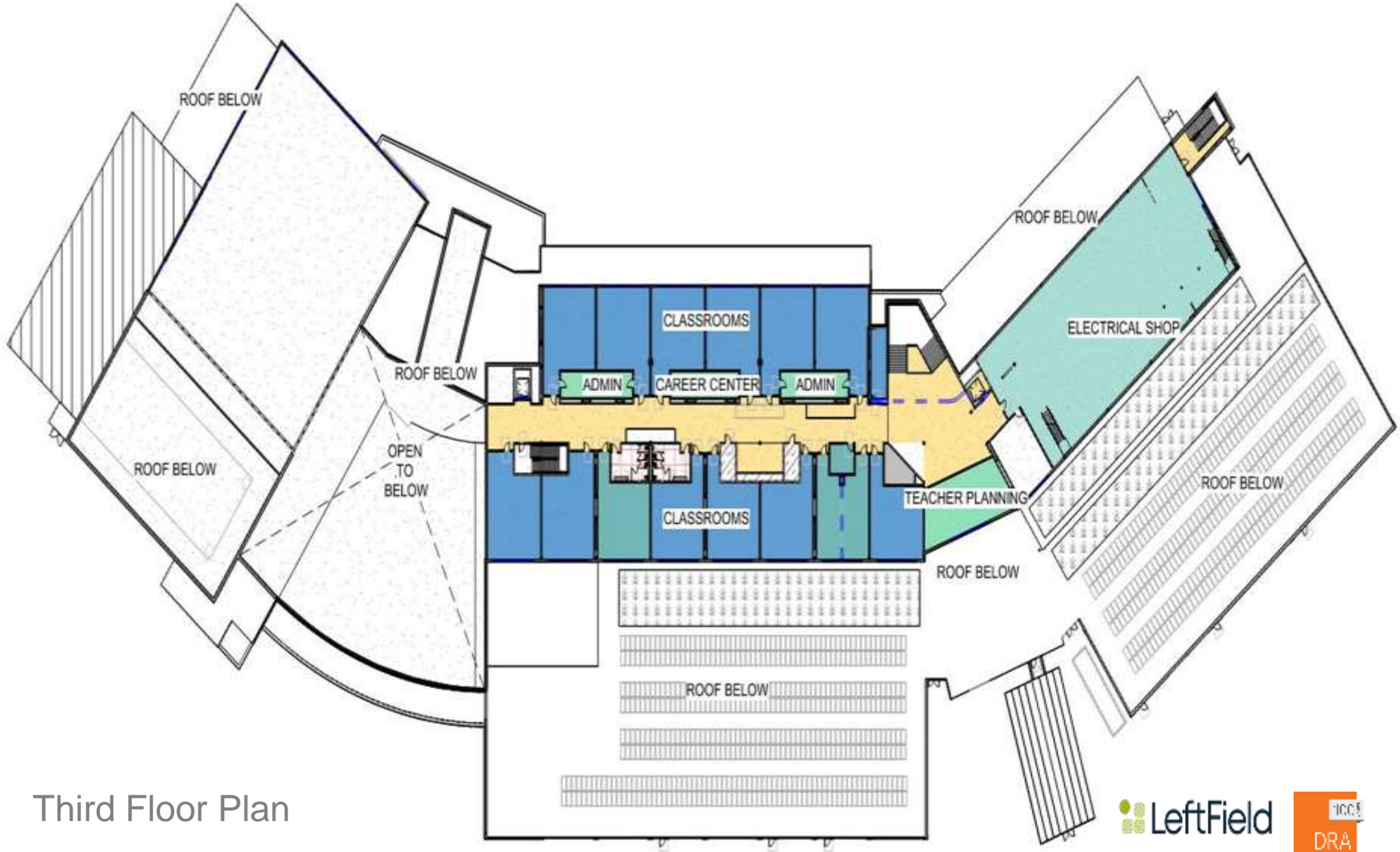

Third Floor Plan

# COST ESTIMATE COMPARISON

	Option AR 1.0 Add/Reno 805 Students	Option AR 1.0 Add/Reno 900 Students	Option NC 2.0 New 805 Students	Option NC 2.0 New 900 Students	Option NC 2.1 New 805 Students	Option NC 2.1 New 900 Students
<b>Estimated Construction</b>	\$204.5 M (\$857 / sf)	\$216.5 M (\$839 / sf)	\$218 M (\$920 / sf)	\$226 M (\$881 / sf)	\$225 M (\$936 / sf)	\$233 M (\$897 / sf)
<b>Estimated Total Project</b>	\$277.5 M	\$293.5 M	\$274 M	\$283M	\$282 M	\$292 M
<b>Estimated MSBA Share</b>	37.98% \$105.5 M	38.70% \$113.6M	36.34% \$100 M	37.89% \$107 M	35.82% \$101 M	37.25% \$109 M
<b>Estimated District Share</b>	62.02% \$172 M	61.30% \$179.9 M	63.66% \$174 M	62.11% \$176 M	64.18% \$181 M	62.75% \$183 M

# NC 2.0 / CODE UPGRADE COMPARISON

<b>Preferred Option – NC 2.0</b>	<b>Major Code Upgrade</b>
ESTIMATED TOTAL PROJECT COST <b>\$283M</b>	ESTIMATED TOTAL PROJECT COST <b>\$110M</b>
ESTIMATED MSBA SHARE <b>\$107M</b>	ESTIMATED MSBA SHARE <b>\$0</b>
ESTIMATED DISTRICT SHARE <b>\$176M (incl escalation)</b>	ESTIMATED DISTRICT SHARE <b>\$110M (not incl escalation)</b>
Meets educational and student enrollment needs	Does NOT meet educational and student enrollment needs
Provides appropriately sized spaces	Shrinks existing footprint
Ability to add 2 new programs	May require downsizing existing programs



# Regional Agreement Amendment

Town	current % share
Abington	16.7%
Cohasset	1.49%
Hanover	11.06%
Hanson	13.03%
Norwell	4.1%
Rockland	22.77%
Scituate	6.6%
Whitman	24.25%
Marshfield	TBD

**Current process:** Marshfield debt share will adjust based on enrollment for FY26, 27, 28, 29 and then will be fixed in preparation for FY30.

**Note: Fall 2024 Town Meetings: Likely amendment to move all towns to an adjustable debt share model using rolling 4 year averages. Will provide more information.**

The benefit is that it is more of a “pay as you go” model over time, and by using rolling averages it eliminates volatility that comes with changes in enrollment.

# Summary of Next Steps

## **1. By the end of the Summer**

- a. Marshfield's membership begins as of July 1st
- b. Class of 2028 starts in late August
- c. Schematic Design finished late August
- d. Regional Agreement Amendment language finalized and shared

## **1. By the end of October/November**

- a. MSBA Project Approval
- b. Project budget, MSBA grant official
- c. Special town meetings on regional agreement amendment

## **1. By the end of January 2025**

- a. Districtwide vote on project