

# SOUTH SHORE Technical High School

Hanover, Massachusetts



School Building Committee

April 25, 2024



100  
YEARS

DRA

# MEETING MINUTES



## **SUGGESTED VOTE:**

**Vote to approve meeting minutes from the March 20, 2024 SBC Meeting.**

# DRA AMENDMENT #4

Total: \$27,797.00



<b>Fee for Basic Services</b>	<b>Original Contract</b>	<b>Previous Amendments</b>	<b>Amount of This Amendment</b>	<b>Total of All Amendments</b>
Feasibility Study/ Schematic Design Phase	\$1,000,000	\$ 66,385.00	\$ 27,797.00	\$ 1,094,182.00
<b>Total Fee</b>	<b>\$1,000,000.00</b>	<b>\$ 66,385.00</b>	<b>\$ 27,797.00</b>	<b>\$ 1,094,182.00</b>

## AMENDMENT SCOPE:

### Hazmat Sampling, Analysis & Estimate:

Fee: \$25,270.00

10% DRA Markup: \$2,527.00

**Total Amendment #4: \$27,797.00**

## SCHEDULE FOR WORK:

- Samples collected over April Vacation
- Estimate to be prepared to include in SD Project Estimate Set

# INVOICES

Total: \$84,000.00



INVOICES						
ProPay Code	Invoice Date	Vendor	Invoice #	Budget Category	Description of Services	Invoice \$
0001-0000	3/31/24	LeftField	12	OPM – Feasibility Study/ Schematic Design	OPM Feasibility Study Services March 1 – March 31, 2024	\$29,000.00
0002-0000	3/31/24	DRA	7	A/E - Feasibility Study/ Schematic Design	A/E Feasibility Study Services March 1 – March 31, 2024	\$55,000.00
					<b>TOTAL:</b>	<b>\$84,000.00</b>

# BUDGET UPDATE

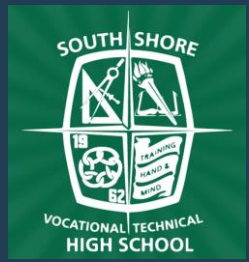

South Shore Regional Vocational Technical High School - Hanover, MA

April 30, 2024

## Total Project Budget Status Report

ProPay Code	Description	Total Project Budget	Authorized Changes	Revised Total Budget	Total Committed	% Cmtd to Date	Actual Spent to Date	% Spent to Date	Balance To Spend	Comments
<b>FEASIBILITY STUDY AGREEMENT</b>										
0001-0000	OPM Feasibility Study/Schematic Design	\$ 400,000	\$28,050	\$ 428,050	\$ 428,050	100%	\$ 323,900	76%	\$ 104,150	1
0002-0000	A&E Feasibility Study/Schematic Design	\$ 1,100,000		\$ 1,100,000	\$ 1,094,182	99%	\$ 594,446	54%	\$ 505,554	
0003-0000	Environmental & Site	\$ 300,000		\$ 300,000	\$ -	0%	\$ -	0%	\$ 300,000	
0004-0000	Other	\$ 200,000	\$ (28,050)	\$ 171,950	\$ -	0%	\$ -	0%	\$ 171,950	
	<b>SUB-TOTAL</b>	<b>\$ 2,000,000</b>	<b>\$ -</b>	<b>\$ 2,000,000</b>	<b>\$ 1,522,232</b>	<b>76%</b>	<b>\$ 918,346</b>	<b>46%</b>	<b>\$ 1,081,654</b>	
<b>TOTAL PROJECT BUDGET</b>		<b>\$ 2,000,000</b>	<b>\$ -</b>	<b>\$ 2,000,000</b>	<b>\$ 1,522,232</b>	<b>76%</b>	<b>\$ 918,346</b>	<b>46%</b>	<b>\$ 1,081,654</b>	
<b>FUNDING SOURCES</b>										
	Maximum State Share	\$ 1,112,600		\$ 1,112,600						
	Local Share	\$ 887,400		\$ 887,400						
	<b>SUB-TOTAL</b>	<b>\$ 2,000,000</b>	<b>\$ -</b>	<b>\$ 2,000,000</b>	<b>\$ 2,000,000</b>	<b>\$ -</b>	<b>\$ -</b>	<b>2,000,000</b>	<b>55.63%</b>	

- All Contract Amendments have been committed against the original budget to indicate the remaining funds in each Budget Category
- All Invoices have been indicated in the Budget

**Committed: 76%**  
**Expended: 46%**

- Uncommitted Funds: \$477,768
- Anticipated Extra Services/ Reimbursables: \$200,000
- Remaining Funds: \$277,768

# MSBA UPDATE



The MSBA Approved the South Shore Tech project to proceed into the Schematic Design phase at their April 24, 2024 Board of Directors Meeting

- Next Steps:
  - Submit Schematic Design Budget to MSBA by mid-August
  - Submit Schematic Design Report to MSBA by August 29, 2024

LeftField has met with MSBA and determined that the District's reimbursement rate is weighted based on the sending communities' enrollment numbers

# CM AT-RISK UPDATE



## CM at-RISK PROCUREMENT

- 3/27/24 – Statement of Qualifications (SOQs) Due
- 4/04/24 – Selection Committee Met to Review SOQs
- 4/08/24 – Request for Proposals (RFP) sent to qualified CMs
- 5/1/24 – Technical and Price Proposals Due
- 5/9 – 5/10 - Selection Committee Interviews CMs
- 5/10/24 – Selection Committee Deliberations
- 5/10/24 – Notice of Award
- TBD - SBC Approves CM Contract

## AVAILABLE FEASIBILITY FUNDS

- Uncommitted Funds Sufficient
- \$ 277,768 Feasibility Study Contingency
- Expected CMR Feasibility Pre-Con Fee range: \$55,000 to \$65,000

**All Prequalification/Selection Committee Meetings, including CM Interviews, are public meetings.**

1. Programming Interviews
2. Schematic Design Update
3. Sustainability





# SOUTH SHORE Technical High School

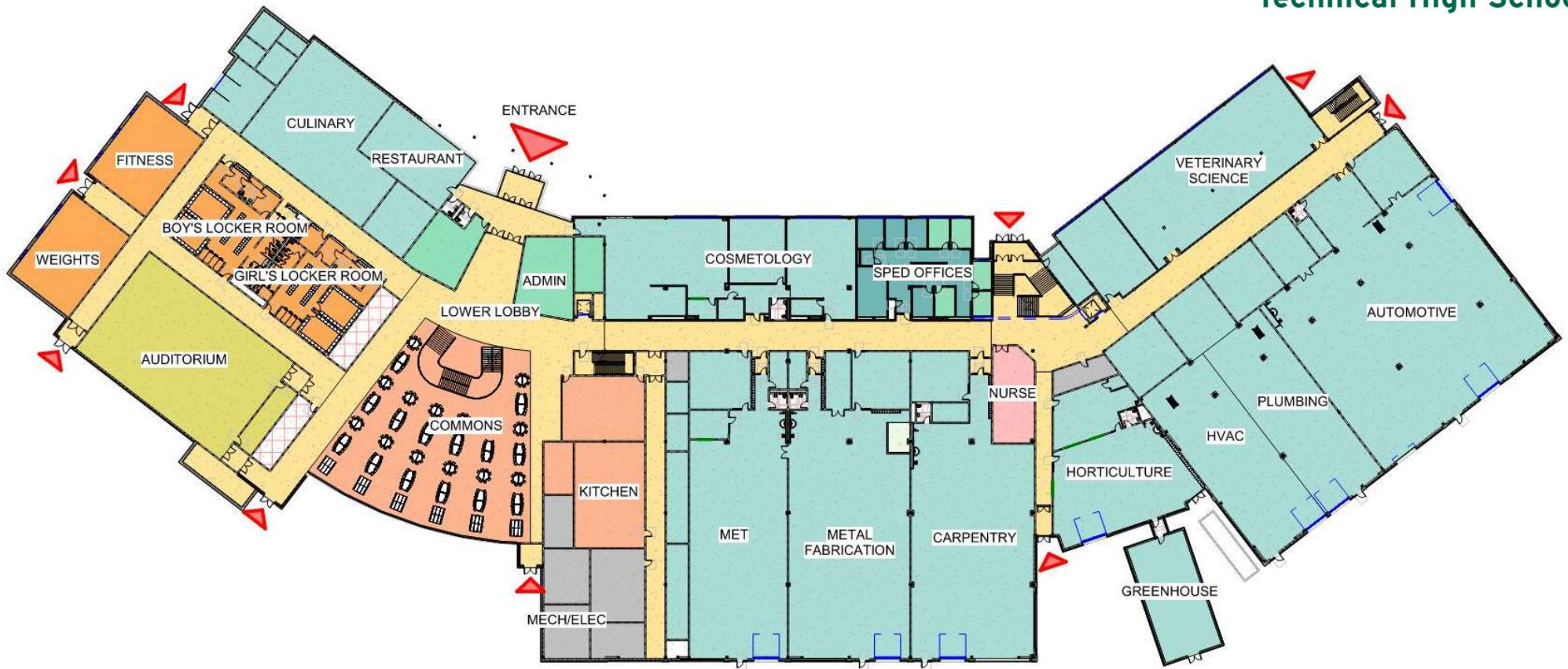

First Floor Plan



# SOUTH SHORE Technical High School

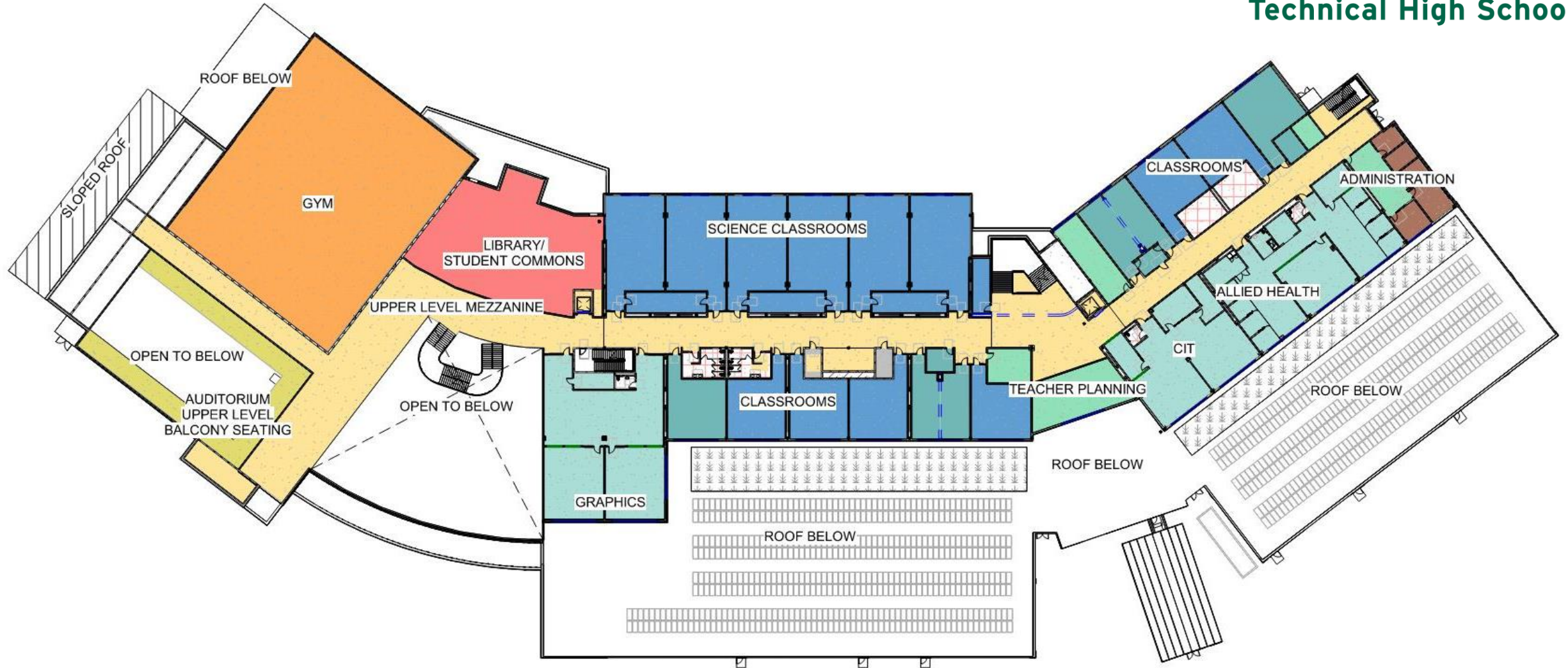

Second Floor Plan





## SUMMARY LEED SCORECARD - New Construction

Yes	?	+	?	-	No	Credit	Description		
						1	Credit	Integrative Process	1
<b>0</b>	<b>2</b>	<b>2</b>	<b>2</b>	<b>11</b>			<b>Location and Transportation</b>	<b>15</b>	
							Credit	LEED for Neighborhood Development Location	15
						1	Credit	Sensitive Land Protection	1
						2	Credit	High Priority Site	2
						5	Credit	Surrounding Density and Diverse Uses	5
						4	Credit	Access to Quality Transit	4
						1	Credit	Bicycle Facilities	1
						1	Credit	Reduced Parking Footprint	1
						1	Credit	Green Vehicles	1
<b>8</b>	<b>0</b>	<b>3</b>	<b>1</b>				<b>Sustainable Sites</b>	<b>12</b>	
Y							Prereq	Construction Activity Pollution Prevention	Required
Y							Prereq	Environmental Site Assessment	Required
1							Credit	Site Assessment	1
1						1	Credit	Site Development - Protect or Restore Habitat	2
1							Credit	Open Space	1
3							Credit	Rainwater Management	3
						2	Credit	Heat Island Reduction	2
1							Credit	Light Pollution Reduction	1
						1	Credit	Site Master Plan	1
1							Credit	Joint Use of Facilities	1
<b>6</b>	<b>2</b>	<b>1</b>	<b>3</b>				<b>Water Efficiency</b>	<b>12</b>	
Y							Prereq	Outdoor Water Use Reduction	Required
Y							Prereq	Indoor Water Use Reduction	Required
Y							Prereq	Building-Level Water Metering	Required
1	1						Credit	Outdoor Water Use Reduction	2
4	1	1	1				Credit	Indoor Water Use Reduction	7
						2	Credit	Cooling Tower Water Use	2
1							Credit	Water Metering	1
<b>20</b>	<b>1</b>	<b>1</b>	<b>9</b>				<b>Energy and Atmosphere</b>	<b>31</b>	
Y							Prereq	Fundamental Commissioning and Verification	Required
Y							Prereq	Minimum Energy Performance	Required
Y							Prereq	Building-Level Energy Metering	Required
Y							Prereq	Fundamental Refrigerant Management	Required
6							Credit	Enhanced Commissioning	6
14						2	Credit	Optimize Energy Performance	14
						1	Credit	Advanced Energy Metering	1
						2	Credit	Demand Response	2
						1	Credit	Renewable Energy Production	1
						1	Credit	Enhanced Refrigerant Management	1

						2	Credit	Green Power and Carbon Offsets	2
<b>4</b>	<b>1</b>	<b>1</b>	<b>7</b>				<b>Materials and Resources</b>	<b>13</b>	
Y							Prereq	Storage and Collection of Recyclables	Required
Y							Prereq	Construction and Demolition Waste Management Planning	Required
						5	Credit	Building Life-Cycle Impact Reduction	5
1						1	Credit	Building Product Disclosure and Optimization - Environmental Product Declarations	2
						2	Credit	Building Product Disclosure and Optimization - Sourcing of Raw Materials	2
1	1						Credit	Building Product Disclosure and Optimization - Material Ingredients	2
2							Credit	Construction and Demolition Waste Management	2
<b>8</b>	<b>1</b>	<b>0</b>	<b>7</b>				<b>Indoor Environmental Quality</b>	<b>16</b>	
Y							Prereq	Minimum Indoor Air Quality Performance	Required
Y							Prereq	Environmental Tobacco Smoke Control	Required
Y							Prereq	Minimum Acoustic Performance	Required
2							Credit	Enhanced Indoor Air Quality Strategies	2
3							Credit	Low-Emitting Materials	3
1							Credit	Construction Indoor Air Quality Management Plan	1
1						1	Credit	Indoor Air Quality Assessment	2
						1	Credit	Thermal Comfort	1
1						1	Credit	Interior Lighting	2
						3	Credit	Daylight	3
1							Credit	Quality Views	1
						1	Credit	Acoustic Performance	1
<b>6</b>	<b>0</b>	<b>0</b>	<b>0</b>				<b>Innovation</b>	<b>6</b>	
1							Credit	Innovation : Pilot Embodied carbon	1
1							Credit	Innovation - Exemplary EPD	1
1							Credit	Innovation - Exemplary MI	1
1							Credit	Innovation - Occupant Education / Teaching tool	1
1							Credit	Innovation - O+M Starter Kit (pest, landscape)	1
1							Credit	LEED Accredited Professional	1
<b>4</b>	<b>0</b>	<b>0</b>	<b>2</b>				<b>Regional Priority</b>	<b>4</b>	
1							Credit	Regional Priority: Open Space, min. 1 point	1

<b>56</b>	<b>7</b>	<b>8</b>	<b>41</b>	<b>TOTALS</b>	<b>Possible Points: 110</b>
<b>Certified: 40 to 49 points, Silver: 50 to 59 points, Gold: 60 to 79 points, Platinum: 80 to 110</b>					

MSBA Incentive:  
4 Additional  
reimbursement points